

MODEL# **20D**  
**UL762 UPBLAST EXHAUST FAN**  
**DIRECT DRIVE**

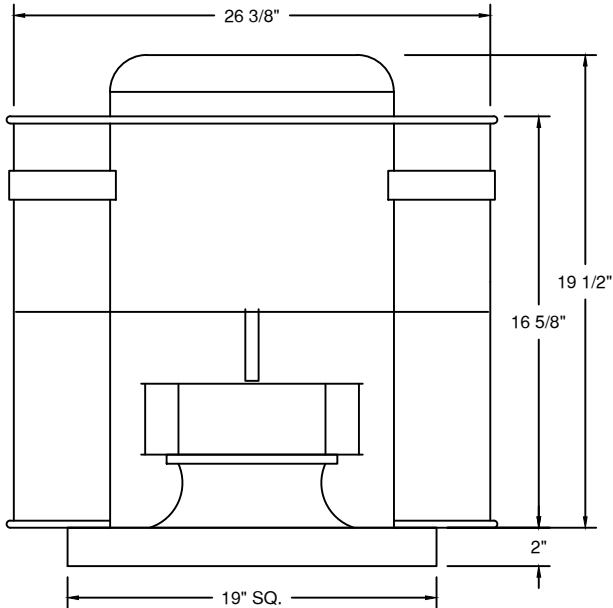

**DIMENSIONAL DATA**  
17 1/2" SQ. CURB

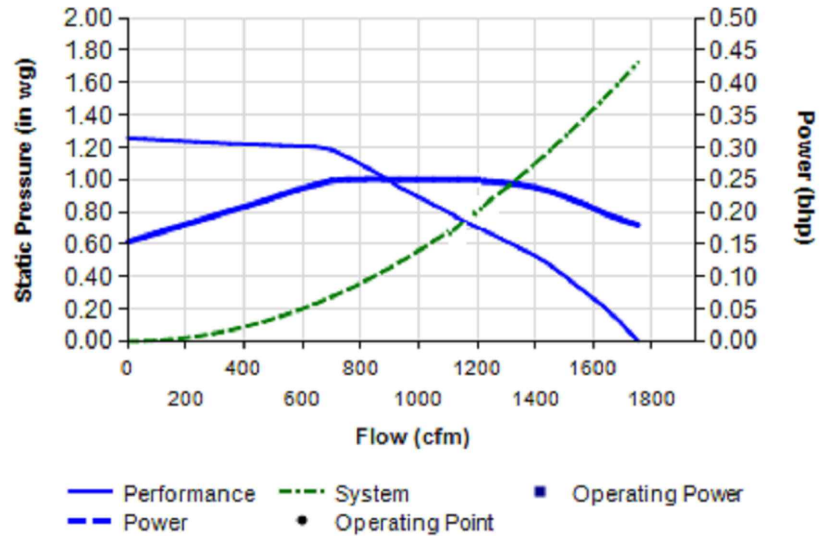

**PERFORMANCE DATA**

|              |     |              |     |
|--------------|-----|--------------|-----|
| <b>PHASE</b> | 1   | <b>VOLTS</b> | 115 |
| <b>AMPS</b>  | 2.6 | <b>HP</b>    | 1/4 |

| RPM  | .000" S.P. |      | .125" S.P. |      | .250" S.P. |      | .375" S.P. |      | .50" S.P. |      | .625" S.P. |      | .750" S.P. |      |
|------|------------|------|------------|------|------------|------|------------|------|-----------|------|------------|------|------------|------|
|      | CFM        | Sone | CFM        | Sone | CFM        | Sone | CFM        | Sone | CFM       | Sone | CFM        | Sone | CFM        | Sone |
| 1680 | 1753       | 13.8 | 1689       | 13.7 | 1611       | 13.6 | 1522       | 13.6 | 1433      | 13.5 | 1295       | 13.2 | 1155       | 13.1 |

**STANDARD FEATURES**

- HEAVY GAUGE ALUMINUM HOUSING
- 1 YEAR LIMITED WARRANTY ON ALL ELECTRIC MOTORS
- FACTORY SET DRIVE
- BELT DRIVEN MOTORS ARE ENCLOSED IN WEATHER-TIGHT COMPARTMENTS
- AVERAGE UNIT WEIGHT: 50 LBS
- AVERAGE SHIPPING WEIGHT: 72 LBS

